

Courses & Distances Beg<sup>d</sup> WOC  
 East 48 1/2 WOC  
 N 63 E 60 BOX  
 S 27 E 54 WOC  
 N 77 E 44 WOC  
 N 56 E 26 Elm  
 East 88 WOC  
 N 7 E 28 WOC  
 West 62 Spanish Oak  
 N 70 W 94 Gum  
 N 10 W 44 Spanish Oak  
 S 59 W 32 Post  
 S 69 W 59 WOC  
 N 66 W 37 WOC  
 S 60 W 30 Maple  
 S 57 W 36 WOC  
 N 68 E 27 WOC  
 S 17 W 120 to Beg<sup>d</sup>

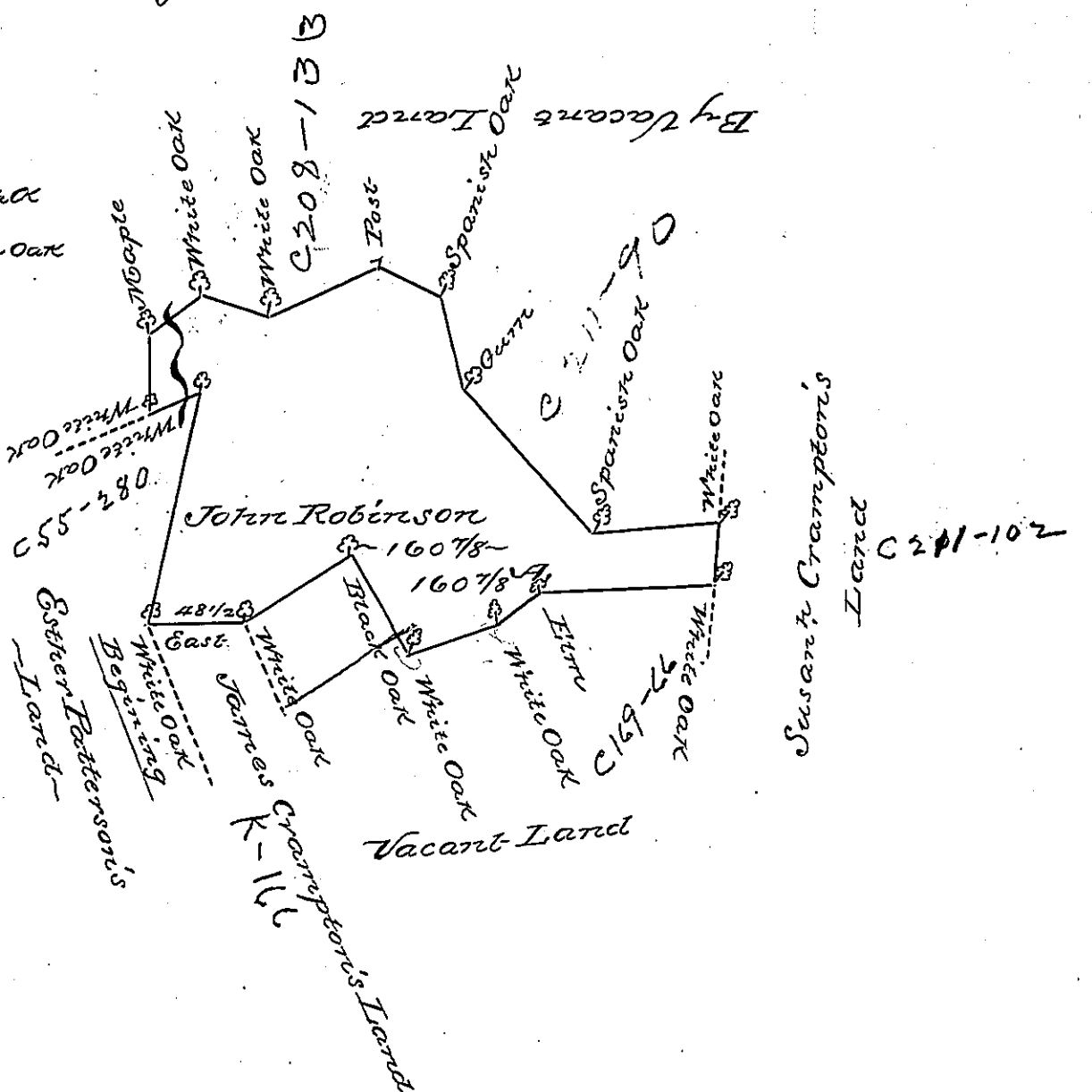

The Draught of a Tract of Land called \_\_\_\_\_  
 situate on the Delaware River in the County  
 of Cumberland containing One Hundred Sixty  
 Acres 148 Perches, with usual Allowance for Roads,  
 Survey'd the 9<sup>th</sup> day of September Anno Dom: 1770  
 In Pursuance of an Order of Survey to John Rob-  
 binson Bearing Date at Philad: the Twenty Eighth  
 day of April Anno Dom: 1767 N 3539

To John Lukens Esq }  
 of Pennsylvania } Wm Moaclay D<sup>y</sup>

IN TESTIMONY that the above is a copy of the original remaining on file in  
 the Department of Internal Affairs of Pennsylvania, made  
 conformably to an Act of Assembly approved the 16th day of  
 February, 1833, I have hereunto set my Hand and caused  
 the Seal of said Department to be affixed at Harrisburg,  
 this second day of August 1898

*James W. Patton*  
 Secretary of Internal Affairs.